

# GS/DURAPULSE Accessories – Fusing

## Fusing Overview

Circuit protection devices are essential to prevent costly damage to your AC drive application equipment. Fuses and fuse kits are available from AUTOMATIONDIRECT for the GS2 and DURAPULSE AC drives. (AutomationDirect GS style fuses and fuse

kits are NOT available for GS1 drives at this time.)

The fuse specifications are shown in the table below. Each fuse kit consists of one fuse block and fuses sized to handle the inrush current while providing superior protection for the corresponding GS2 or DURAPULSE AC drive. The larger drives in

the DURAPULSE family require three fuse kits (one per phase). Their part numbers are marked in the table with a double asterisk.

Replacement fuses are also available, and listed in the table next to their companion fuse kits.

**Fuse Kit Specifications for GS2 and DURAPULSE 115~460V Drives**

Fuse Kit *	Fuse Block Type	Wire Range	Fuse Type	Fuse Block Dimensions	Fuse Rating	Replacement Fuses (5 fuses per package)			
<b>GS-10P2-FKIT-1P**</b>	Two-pole	Al/Cu #2-14	A3T	Figure 1	300V@20A	<b>GS-10P2-FUSE-1P</b>			
<b>GS-10P5-FKIT-1P**</b>					300V@20A	<b>GS-10P5-FUSE-1P</b>			
<b>GS-11P0-FKIT-1P**</b>					300V@20A	<b>GS-11P0-FUSE-1P</b>			
<b>GS-20P5-FKIT-1P</b>					300V@20A	<b>GS-20P5-FUSE-1P</b>			
<b>GS-20P5-FKIT-3P</b>	Three-pole			Al/Cu #2-14	A3T	Figure 2	300V@10A	<b>GS-20P5-FUSE-3P</b>	
<b>GS-21P0-FKIT-1P</b>	Two-pole					Figure 1	300V@30A	<b>GS-21P0-FUSE-1P</b>	
<b>GS-21P0-FKIT-3P</b>	Three-pole					Figure 2	300V@20A	<b>GS-21P0-FUSE-3P</b>	
<b>GS-22P0-FKIT-1P</b>	Two-pole					Figure 1	300V@45A	<b>GS-22P0-FUSE-1P</b>	
<b>GS-22P0-FKIT-3P</b>	Three-pole					Figure 2	300V@25A	<b>GS-22P0-FUSE-3P</b>	
<b>GS-23P0-FKIT-1P</b>	Two-pole					Figure 1	300V@60A	<b>GS-23P0-FUSE-1P</b>	
<b>GS-23P0-FKIT-3P</b>	Three-pole					Figure 2	300V@40A	<b>GS-23P0-FUSE-3P</b>	
<b>GS-25P0-FKIT</b>						300V@60A	<b>GS-25P0-FUSE</b>		
<b>GS-27P5-FKIT</b>		Figure 3	300V@100A			<b>GS-27P5-FUSE</b>			
<b>GS-2010-FKIT</b>		Figure 4	300V@125A			<b>GS-2010-FUSE</b>			
<b>GS-2015-FKIT</b>	Three-pole	Al/Cu 2/0-#6	A3T			Figure 4	300V@175A	<b>GS-2015-FUSE</b>	
<b>GS-2020-FKIT</b>							Figure 5	300V@250A	<b>GS-2020-FUSE</b>
<b>GS-2025-FKIT</b>				300V@300A	<b>GS-2025-FUSE</b>				
<b>GS-2030-FKIT</b>				300V@350A	<b>GS-2030-FUSE</b>				
<b>GS-2040-FKIT***</b>	One-pole			Figure 6 ***	300V@450A	<b>GS-2040-FUSE</b>			
<b>GS-2050-FKIT***</b>	One-pole				300V@500A	<b>GS-2050-FUSE</b>			
<b>GS-41P0-FKIT</b>	Three-pole			Al/Cu #2-14	A6T	Figure 7	600V@10A	<b>GS-41P0-FUSE</b>	
<b>GS-42P0-FKIT</b>							600V@15A	<b>GS-42P0-FUSE</b>	
<b>GS-43P0-FKIT</b>							600V@20A	<b>GS-43P0-FUSE</b>	
<b>GS-45P0-FKIT</b>							600V@30A	<b>GS-45P0-FUSE</b>	
<b>GS-47P5-FKIT</b>	Three-pole			Al/Cu #2-14		A6T	Figure 8	600V@50A	<b>GS-47P5-FUSE</b>
<b>GS-4010-FKIT</b>							Figure 9	600V@70A	<b>GS-4010-FUSE</b>
<b>GS-4015-FKIT</b>		600V@90A	<b>GS-4015-FUSE</b>						
<b>GS-4020-FKIT</b>		Figure 10	600V@125A				<b>GS-4020-FUSE</b>		
<b>GS-4025-FKIT</b>	600V@150A		<b>GS-4025-FUSE</b>						
<b>GS-4030-FKIT</b>	600V@175A		<b>GS-4030-FUSE</b>						
<b>GS-4040-FKIT***</b>	One-pole	Al/Cu 2/0-#6	A6T	Figure 11 ***			600V@225A	<b>GS-4040-FUSE</b>	
<b>GS-4050-FKIT***</b>							600V@250A	<b>GS-4050-FUSE</b>	
<b>GS-4060-FKIT***</b>					600V@350A		<b>GS-4060-FUSE</b>		
<b>GS-4075-FKIT***</b>					600V@400A		<b>GS-4075-FUSE</b>		
<b>GS-4100-FKIT***</b>	One-pole	Al/Cu 2/0-#6		A6T	Figure 12 ***		600V@600A	<b>GS-4100-FUSE</b>	

**NOTES:**

- \* - AutomationDirect GS style fuses and fuse kits are NOT available at this time for GS1 drives.
- \*\* - Single phase 115V fuse kits are for use only with GS2 drives.
- \*\*\* - Kit includes three single-pole fuse blocks and three fuses.

# GS/DURAPULSE Accessories – Fusing

Fuse Specifications for GS2 575V Drives					
GS2 Drive Model	Edison Fuse Block	Fuse Block Type	Fuse Class	Fuse Rating	Edison Fuses (10 fuses per pack)
GS2-51P0	BC6033PQ or CHCC3D or CHCC3DI	3-pole or 3-pole modular or 3-pole modular indicating	CC	6A@600V	HCLR6
GS2-52P0				10A@600V	HCLR10
GS2-53P0				15A@600V	HCLR15
GS2-55P0				20A@600V	HCLR20
GS2-57P5				30A@600V	HCLR30
GS2-5010					

**NOTE:**  
Refer to the Edison Fuses section of this catalog for pricing, specifications, and dimensions.

## Fuse Block Dimensions

Units = inches

Figure 1

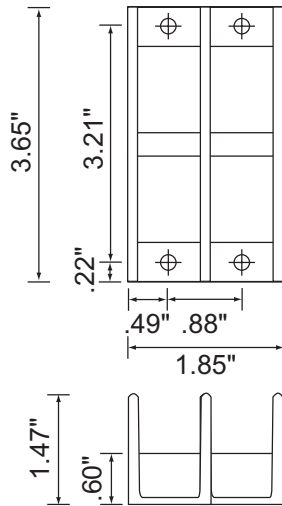

Figure 2

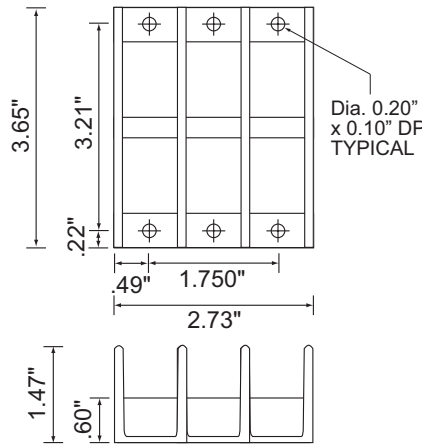

Figure 3

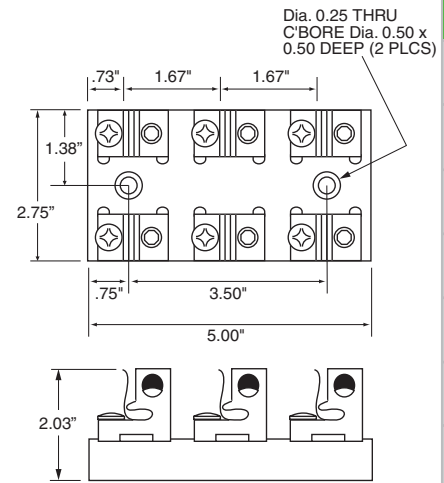

Figure 4

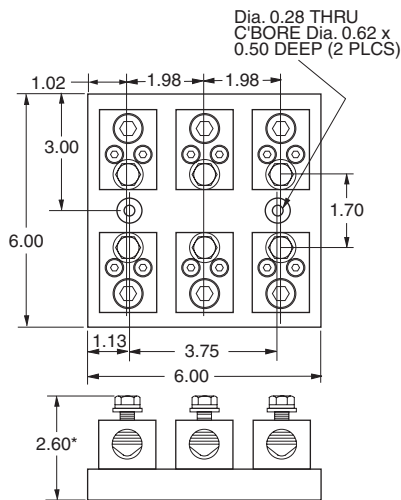

Figure 5

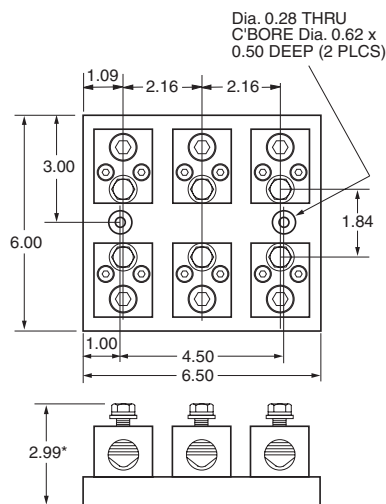
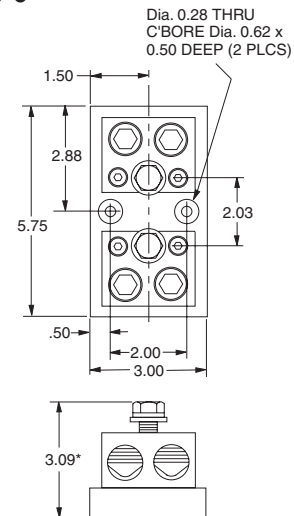

Figure 6



- PLC Overview
- DL05/06 PLC
- DL105 PLC
- DL205 PLC
- DL305 PLC
- DL405 PLC
- Field I/O
- Software
- C-more HMIs
- Other HMI
- AC Drives
- Motors
- Steppers/Servos
- Motor Controls
- Proximity Sensors
- Photo Sensors
- Limit Switches
- Encoders
- Pushbuttons/Lights
- Process
- Relays/Timers
- Comm.
- TB's & Wiring
- Power
- Enclosures
- Appendix
- Part Index

# GS/DURAPULSE Accessories – Fusing

## Fuse Block Dimensions

Units = inches

Figure 7

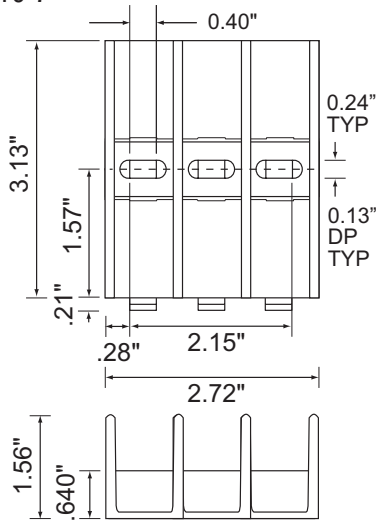

Figure 8

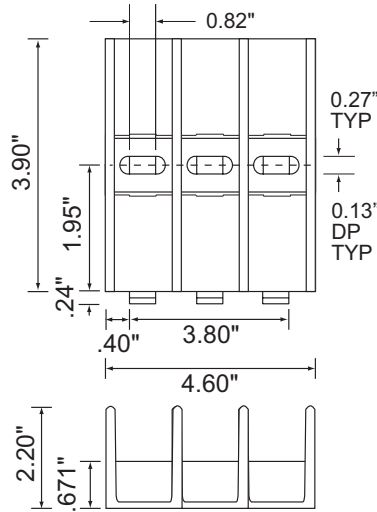

Figure 9

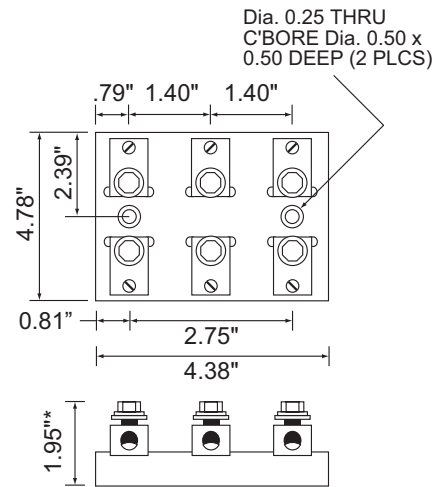

Figure 10

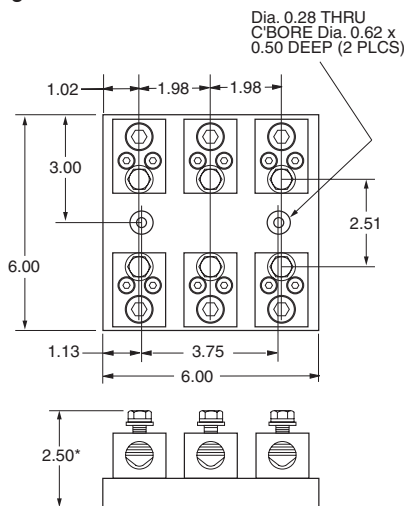

Figure 11

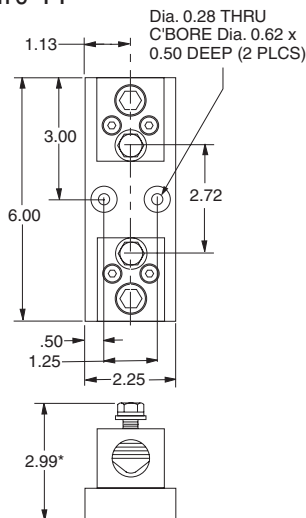
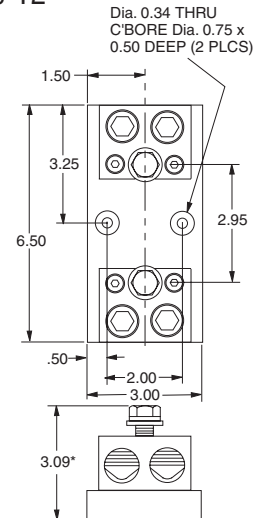

Figure 12



\* Height includes nominal fuse blade thickness.