

DINnectors Accessories

End Brackets

The DN-EB15 end brackets mount on 15 mm DIN rail, and DN-(Q)EB35(-A) end brackets are designed to mount on 35 mm DIN rail. End brackets are used to prevent components from sliding along the rail.

Part Number	Description	Pcs/Pkg	Price/Pkg
DN-EB15	Terminal block end stop 7mm width screw clamping. Gray	100	<-->
DN-EB15MN		20	<-->
DN-EB35	Terminal block end stop 9mm width screw clamping. Gray	50	<-->
DN-EB35MN		20	<-->
DN-EB35-A	Terminal block end stop 6mm width screw clamping. Black	50	<-->
DN-EB35-A-10		10	<-->
DN-QEB35	Terminal block end stop 6mm width screwless clamping. Black	50	<-->
DN-QEB35-10		10	<-->

DN-EB15

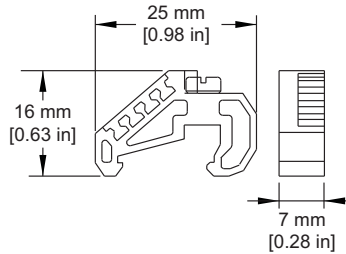

DN-EB35

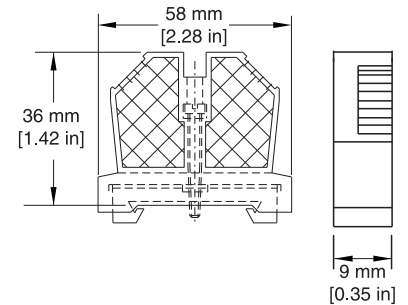

DN-EB35-A

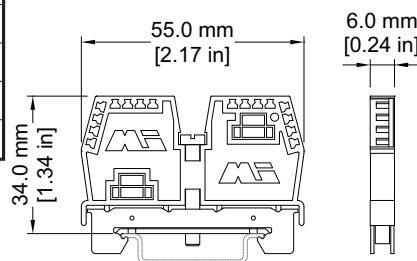

DN-QEB35

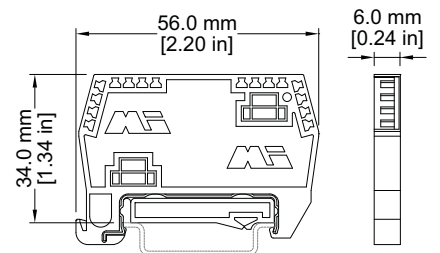

End Covers & Spacers

Certain end covers can be used with multiple terminal block parts to cover and insulate the open side, or to put more space between adjacent blocks.

Part Number	Length	Height	Thickness
DN-EC1210	44 mm [1.73 in]	35 mm [1.38 in]	1.5 mm [0.06 in]
DN-EC1210MN			
DN-EC86	50 mm [1.97 in]	43 mm [1.69 in]	1.5 mm [0.06 in]
DN-EC86MN			

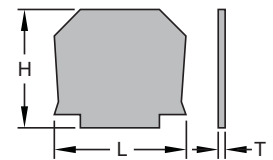

Part Number	Purpose	For TBs:	Pcs/Pkg	Price/Pkg
DN-EC1210	covers open side of TB	DN-T10-A	100	<-->
DN-EC1210MN	covers open side of TB	DN-T12-A	25	<-->
DN-EC86	covers open side of TB	DN-T8	100	<-->
DN-EC86MN	covers open side of TB	DN-T6	25	<-->
DN-EMXM1EC1	covers open side of TB	DN-EMXM1 DN-QEMXM1	25	<-->
DN-EMXM1EC2	covers closed side of TB			<-->
DN-EMXM1SPA1	spacer for either side of TB			<-->
DN-EMXDVEC1	covers open side of TB	DN-EMXDV DN-QEMXDV	25	<-->
DN-EMXDVEC2	covers closed side of TB			<-->
DN-EMXDVSPA1	spacer for either side of TB			<-->
DN-FESEP	covers open side of TB	DN-FEx DN-DISx	50	<-->
DN-FESEP-10	covers open side of TB		10	<-->
DN-FESPA	wider cover open side of TB		50	<-->
DN-FESPA-10	wider cover open side of TB		10	<-->

Note: End covers for DN-M10-A, DN-T4 and DN-KBD12 are found in their respective Accessories table.

DN-EMXM1EC1

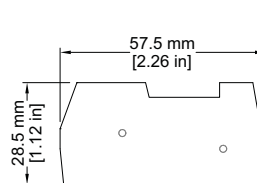

DN-EMXM1EC2

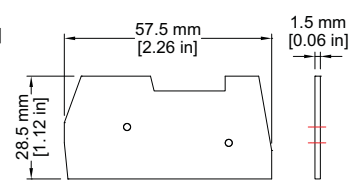

DN-EMXM1SPA1

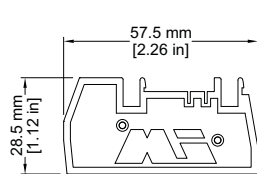

DN-EMXDVSPA1

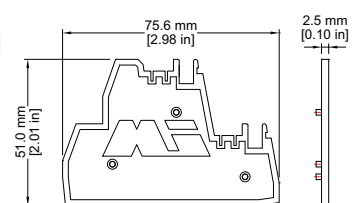

DN-EMDVEC1

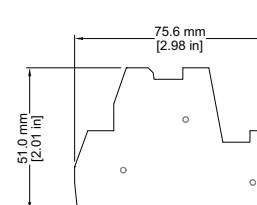

DN-EMDVEC2

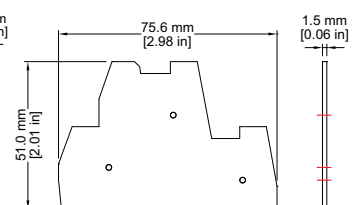

DN-FESEP

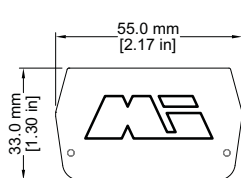

DN-FESEPA

