

C-more Micro-Graphic Panel Accessories

DC Power Adapter

The **C-more** Micro-Graphic panel is designed to use the 5 VDC power that is available from an RJ12 serial communications port of a **Direct** LOGIC PLC from **AutomationDirect**. However, when connecting to a PLC port that does not supply this power, the DC Power Adapter module can be used to provide this

power. The adapter requires power from a 12-24 VDC source. This optional DC Power Adapter for **C-more** Micro-Graphic panels is designed to easily snap on to the rear of a **C-more** Micro-Graphic panel or the rear of an optional Keypad Bezel being used with a Micro-Graphic panel.

Part No. EA-MG-P1



Dimensions

Units: inches [mm]

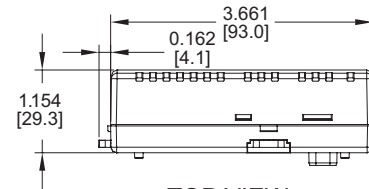

TOP VIEW

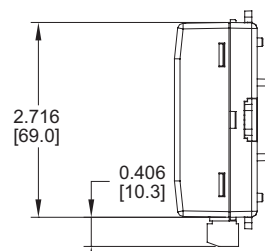

LEFT VIEW

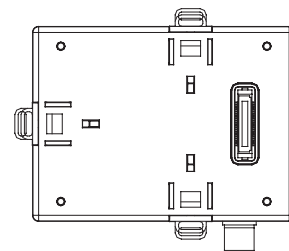

REAR VIEW

Panel Overall Depth with Adapter Installed

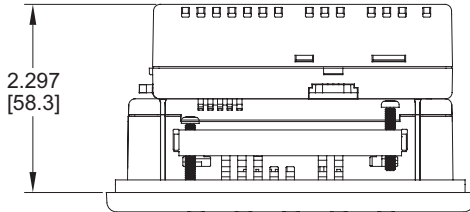

Units: inches [mm]

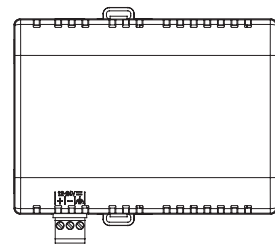

FRONT VIEW

DC Power Adapter Specifications

Part Number	EA-MG-P1
	Electrical
Input Voltage	12-24 VDC
Input Voltage Range	10.8-26.4 VDC
Power Consumption	100 mA @ 24 VDC
Maximum Power	2.90 Watts
Maximum Inrush Current	5 A @ 500 μ s with 12 VDC applied, 10 A @ 500 μ s with 24 VDC applied
Connector Type	3-pin screw type terminal block
	Physical
Dimensions	3.823" (W) x 3.284" (H) x 1.331" (D) [97.1 mm x 83.4 mm x 33.8 mm]
Weight	2.8 oz. [80 g]
Environmental	See Micro-Graphic panel specifications at the beginning of this catalog section.



NOTE: Recommended DC power supply to power either DC Power Adapter, AutomationDirect Part No. PSP24-024S or PSP24-024C.

C-more Micro-Graphic Panel Accessories

Serial Port with DC Power Adapter

The **C-more** Micro-Graphic panel is designed to use the 5 VDC power that is available from an RJ12 serial communications port of a **Direct**LOGIC PLC from **AutomationDirect**. However, for other PLC brands that do not supply power through their serial communication ports, the DC Power Adapter module can be used to provide this power. The adapter, with D-Sub 15-pin RS-232/RS-422/485 serial port, can be used to connect to a PLC using

RS-232 or RS-422/485. The adapter requires power from a 12-24 VDC source. This optional Serial Port with DC Power Adapter for **C-more** Micro-Graphic panels is designed to easily snap on to the rear of a **C-more** Micro-Graphic panel or the rear of an optional Keypad Bezel being used with a Micro-Graphic panel.

Part No. EA-MG-SP1



Supports:
RS-232,
RS-485,
& RS-422

Dimensions

Units: inches [mm]

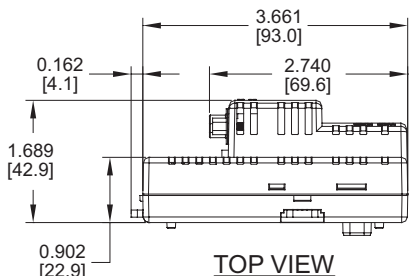

Panel Overall Depth with Adapter Installed

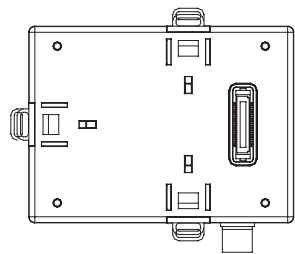
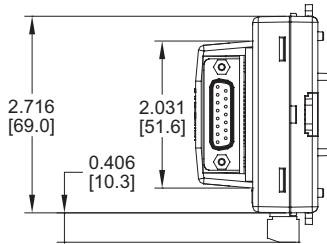
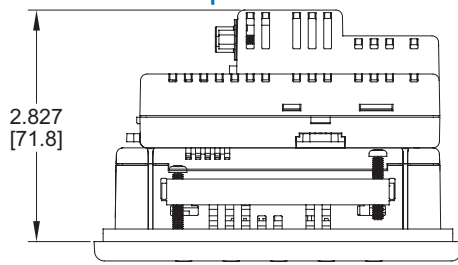

PLC Drivers	
Serial	Avail.
Direct LOGIC K-sequence	Yes
Direct NET	Yes
Modbus (Koyo Addressing)	Yes
Modbus RTU	Yes
Entivity Modbus RTU	Yes

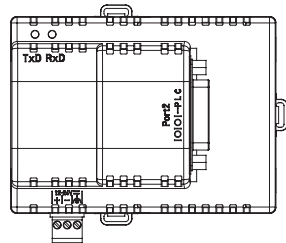

Serial Port w/ DC Power Adapter Specifications	
Part Number	EA-MG-SP1
Serial PLC Interface	
Interface Standard	RS-232 & RS-485/422
Adjustable Settings from Software (Dependent on PLC Protocol)	Baud rate: 9600, 19200 or 38400 bits/sec Data bits: 7/8 bits Parity: None, Odd/Even Stop bits: 2/1 bits
Connector Type	15-pin D-sub connector (female)
Electrical	
Input Voltage	12-24 VDC
Input Voltage Range	10.8-26.4 VDC
Power Consumption	100 mA @ 24 VDC
Maximum Power	2.90 Watts
Maximum Inrush Current	5 A @ 500 μs with 12 VDC applied, 10 A @ 500 μs with 24 VDC applied
Connector Type	3-pin screw type terminal block
Physical	
Dimensions	3.823" (W) x 3.284" (H) x 1.331" (D) [97.1 mm x 83.4 mm x 33.8 mm]
Weight	2.8 oz. [80 g]
Environmental	See Micro-Graphic panel specifications at the beginning of this catalog section.

NOTE: Recommended DC power supply to power either DC Power Adapter, AutomationDirect Part No. PSP24-024S or PSP24-024C.

PLC Serial Communications Port

Pin	Signal	Pin	Signal	Pin	Signal
1	Frame GND	6	LE	11	TXD+ (422/485)
2	TXD (232C)	7	CTS (232C)	12	TXD- (422/485)
3	RXD (232C)	8	RTS (232C)	13	Term. Resistor
4	Vcc	9	RXD+ (422/485)	14	do not use
5	Logic GND	10	RXD- (422/485)	15	do not use

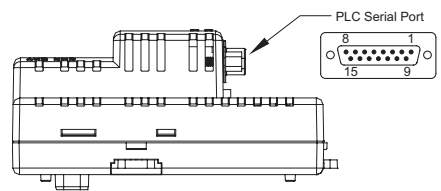

- PLC Overview
- DL05/06 PLC
- DL105 PLC
- DL205 PLC
- DL305 PLC
- DL405 PLC
- Field I/O
- Software
- C-more HMI's**
- Other HMI
- AC Drives
- Motors
- Steppers/Servos
- Motor Controls
- Proximity Sensors
- Photo Sensors
- Limit Switches
- Encoders
- Pushbuttons/Lights
- Process
- Relays/Timers
- Comm.
- TB's & Wiring
- Power
- Enclosures
- Appendix
- Part Index

C-more Micro-Graphic Panel Accessories

Clear Screen Overlay

Optional clear screen overlay used to protect C-more Micro-Graphic displays from minor scratches and wear. Package contains 5 clear screen overlays.

Part No. EA-MG-COV-CL

Dimensions

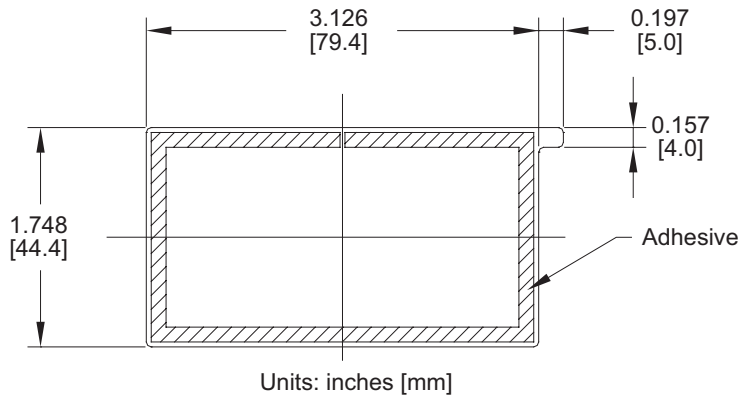

Overlay Cover Installation

Step 1



Step 2

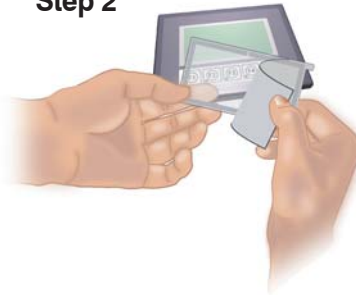

Step 3



C-more Micro-Graphic Replacement Parts

The optional replacement parts can be used to replace damaged, worn or lost C-more Micro-Graphic panel components.

Part Number	Description
EA-MG-S3ML-BRK	Replacement mounting clip for C-more Micro-Graphic panels (pk of 2)
EA-MG-BZ1-BRK	Replacement mounting clip for C-more Micro-Graphic keypad bezel p/n EA-MG-BZ1 (pk of 2)
EA-MG-BZ2-BRK	Replacement mounting clip for C-more Micro-Graphic keypad bezel p/n EA-MG-BZ2 (pk of 6)
EA-MG-DC-CON	Replacement adapter DC power connector for optional p/n EA-MG-P1 and p/n EA-MG-SP1 power adapters used with C-more Micro-Graphic panels (pk of 5)
EA-MG-S3ML-GSK	Replacement mounting gasket for C-more Micro-Graphic panels
EA-MG-BZ1-GSK	Replacement mounting gasket for C-more Micro-Graphic keypad bezel p/n EA-MG-BZ1
EA-MG-BZ2-GSK	Replacement mounting gasket for C-more Micro-Graphic keypad bezel p/n EA-MG-BZ2
EA-MG-S3ML-FKL	Replacement function key label insert for C-more Micro-Graphic panels (pk of 5)

Replacement parts at a glance:

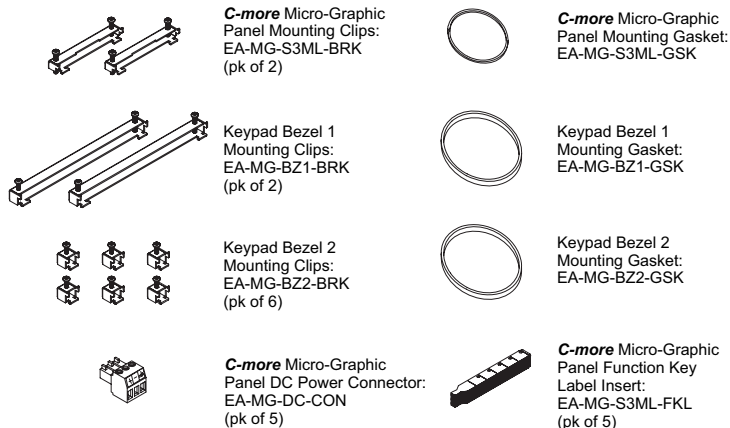

Note: Please refer to the individual data sheet inserts that are included with each replacement part for additional details.

Panel Mounting Clips
Part No. EA-MG-S3ML-BRK



Keypad Bezel 1 Mounting Clips
Part No. EA-MG-BZ1-BRK



Keypad Bezel 2 Mounting Clips
Part No. EA-MG-BZ2-BRK



DC Power Connector
Part No. EA-MG-DC-CON



Panel Gasket
Part No. EA-MG-S3ML-GSK



Keypad Bezel 1 Gasket
Part No. EA-MG-BZ1-GSK



Keypad Bezel 2 Gasket
Part No. EA-MG-BZ2-GSK



Function Keys Label Inserts
Part No. EA-MG-S3ML-FKL

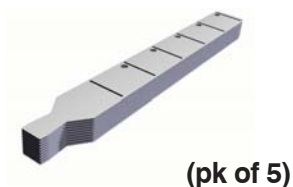

- PLC Overview
- DL05/06 PLC
- DL105 PLC
- DL205 PLC
- DL305 PLC
- DL405 PLC
- Field I/O
- Software
- C-more HMI's**
- Other HMI
- AC Drives
- Motors
- Steppers/Servos
- Motor Controls
- Proximity Sensors
- Photo Sensors
- Limit Switches
- Encoders
- Pushbuttons/Lights
- Process
- Relays/Timers
- Comm.
- TB's & Wiring
- Power
- Enclosures
- Appendix
- Part Index